



# Product Catalogue



[jjcabinetwarehouse.ca](http://jjcabinetwarehouse.ca)

# When it comes to high quality, timeless, readily-available cabinetry, we've got you.

We are committed to providing high quality cabinetry solutions that meet your needs and timelines. More than just a vendor, we act as your partner, providing expert guidance, seamless service, and reliable support from design to delivery.



Our curated selection of cabinets combine timeless elegance with superior craftsmanship, ensuring durability and functionality that stand the test of time. With quality materials, expert construction, and a variety of classic and modern finishes, our cabinetry brings both beauty and reliability to any space.

## Cabinet Details

### BOX CONSTRUCTION

3/4" Furniture Grade Plywood

### DOOR CONSTRUCTION

Solid Wood Rail with MDF Center Panel OR HDF for most Painted Doors

### DOOR HARDWARE

6-Way Adjustable Soft Close Hinges

### DRAWER CONSTRUCTION

Solid Birch with Dovetail Joints

### DRAWER HARDWARE

Full Extension, Adjustable Undermount Soft Close Slider

# Kitchen Cabinet Options

---

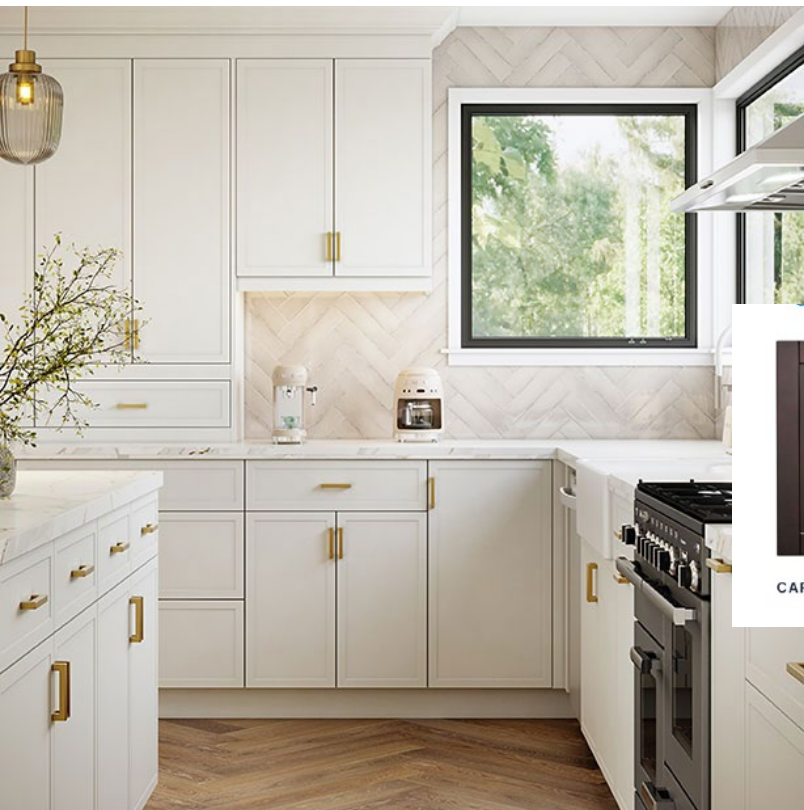

## SIGNATURE HOUSE STOCK



CAPPUCCINO



MAPLE



NARROW WHITE SHAKER



WHITE SLAB



## FUNDAMENTAL



WHITE SHAKER



BERMUDA WHITE



STEP CHARCOAL GREY



FOG GREY



STEP SHAKER WHITE



Kitchen Cabinet Options



TRENDS



OFF WHITE



MIDNIGHT BLUE



BLACK NARROW SHAKER



NATURAL OAK NARROW SHAKER

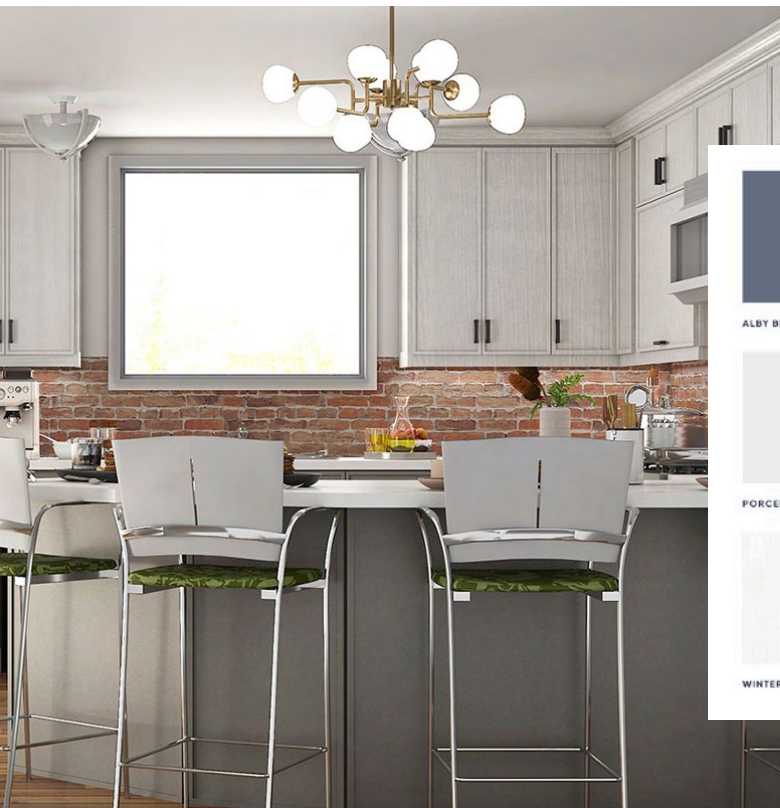

EUROLINE BASIX



ALBY BLUE

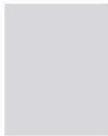

LIGHT GREY



MARINE BLUE



BLACK



CHARCOAL



DUST GREY

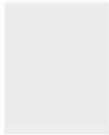

PORCELAIN



REED GREEN

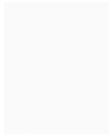

WHITE CLOUD



DALIA WALNUT



HIGHLAND GREEN



AFTER HOURS



WINTER FUN



FASHIONISTA



SHEER BEAUTY

Available in Both Shaker and Slab Door Styles in Thermo Laminate or Laminate Soft Touch Finish



### EUROLINE ULTRA

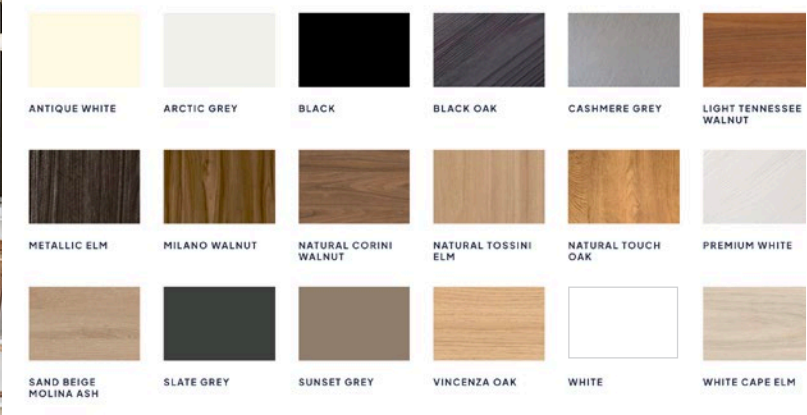

Available in Slab Door Styles in High Gloss, Soft Touch, or Textured Finish



### ECONOLINE



Available in Particleboard



# Vanity Options



## SIGNATURE HOUSE STOCK



CAPPUCCINO



MAPLE



NARROW WHITE SHAKER



## FUNDAMENTAL



STEP CHARCOAL GREY



STEP WHITE SHAKER



BEVELLED BERMUDA WHITE



BEVELLED SHAKER LONDON FOG



BEVELLED SHAKER MIDNIGHT BLUE



BEVELLED SHAKER SANDSTONE



BEVELLED SHAKER RIVERSTONE



BEVELLED SHAKER JAVA



## CRUSH



NARROW WHITE  
SHAKER



NARROW BLACK  
SHAKER



NARROW GREY  
SHAKER



## EVOLUTION



NARROW WHITE  
SHAKER



NARROW NATURAL  
OAK SHAKER



Vanity Options

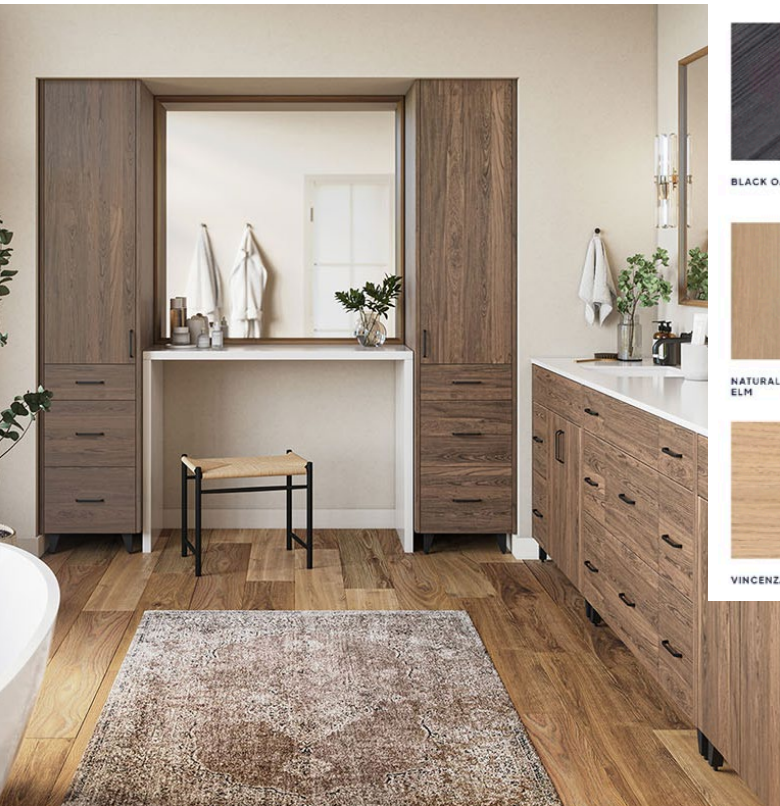

EVOLUTION II

|                     |                   |                        |                       |                |                       |
|---------------------|-------------------|------------------------|-----------------------|----------------|-----------------------|
|                     |                   |                        |                       |                |                       |
| ALBY BLUE           | LIGHT GREY        | MARINE BLUE            | BLACK                 | CHARCOAL       | DUST GREY             |
|                     |                   |                        |                       |                |                       |
| PORCELAIN           | REED GREEN        | WHITE CLOUD            | DALIA WALNUT          | HIGHLAND GREEN | AFTER HOURS           |
|                     |                   |                        |                       |                |                       |
| WINTER FUN          | FASHIONISTA       | SHEER BEAUTY           | ANTIQUE WHITE         | ARCTIC GREY    | BLACK                 |
|                     |                   |                        |                       |                |                       |
| BLACK OAK           | CASHMERE GREY     | LIGHT TENNESSEE WALNUT | METALLIC ELM          | MILANO WALNUT  | NATURAL CORINI WALNUT |
|                     |                   |                        |                       |                |                       |
| NATURAL TOSSINI ELM | NATURAL TOUCH OAK | PREMIUM WHITE          | SAND BEIGE MOLINA ASH | SLATE GREY     | SUNSET GREY           |
|                     |                   |                        |                       |                |                       |
| VINCENZA OAK        | WHITE             | WHITE CAPE ELM         |                       |                |                       |

Available in Both Shaker and Slab Door Styles in High Gloss, Soft Touch, or Matte Finishes



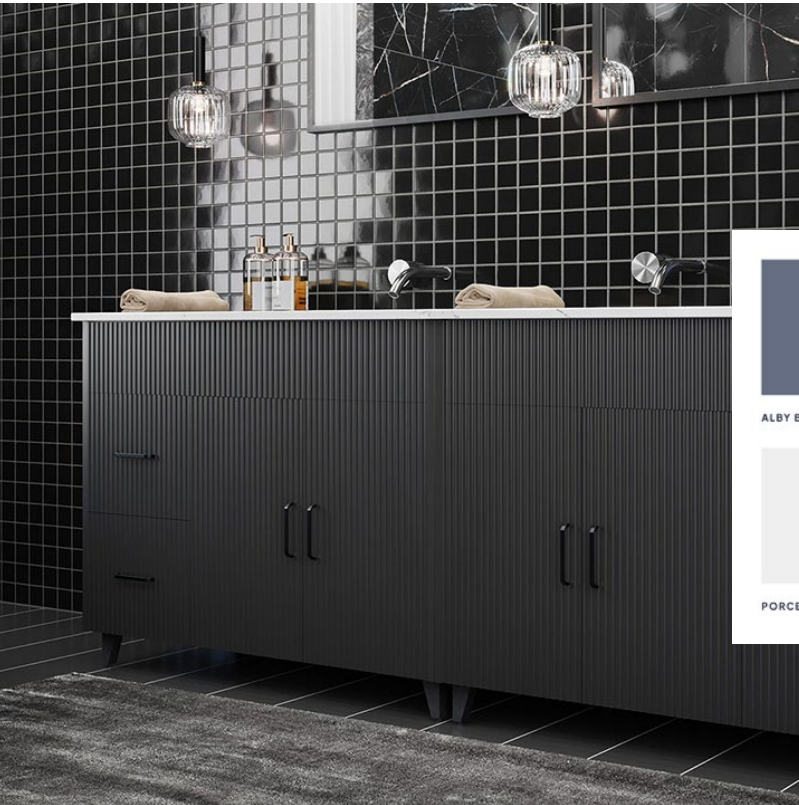

### EVOLUTION III



Available with Fluted MDF Doors



4.8 STARS ON GOGLE

"I highly recommend JJ Cabinets for their excellent customer service, quality of cabinets and timely installation."

**SYL M.**

"Great price, speedy service and awesome customer service!"

**KEN C.**

"What I went through with JJ Cabinets was nothing but top notch stellar work from start to finish...The start to finish of this project felt like I had family helping me. Nothing was ever pressured or pushed, but suggested and explained. With Ryan and Team at the helm, I dont think I would ever look at another place to get a kitchen reno done."

**DAN H.**

"Top quality product and top quality service."

**MARVIN J.**

"The customer service here is like no other. They could teach a masterclass."

**KORTNEE S.**

## BASE CABINETS

### STANDARD

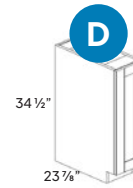
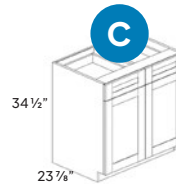
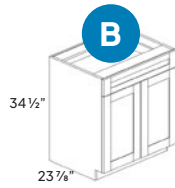
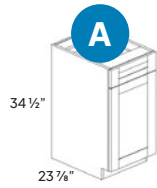

### BLIND CORNER

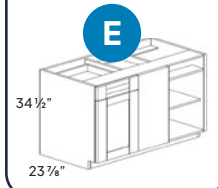

### CORNERS

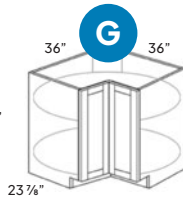
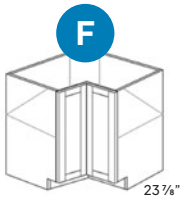

### SINK

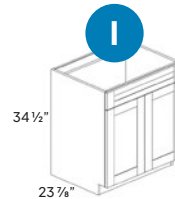
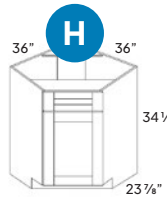

### DRAWERS

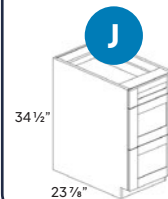

## WALL CABINETS AND PANTRIES

### STANDARD

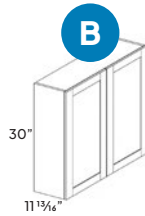
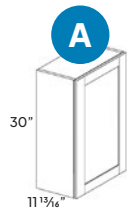

### CORNERS

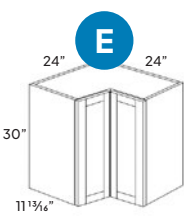
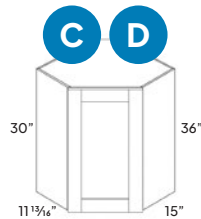

### MICROWAVE

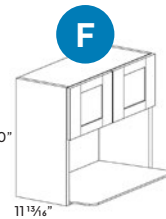

### PANTRIES

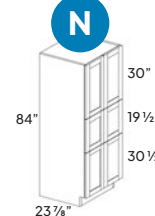
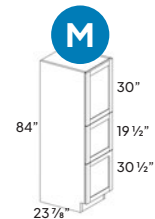

### ABOVE STOVE, SINK & FRIDGE

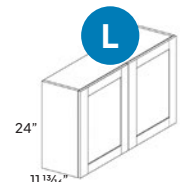
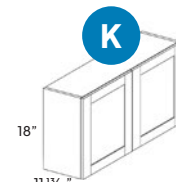
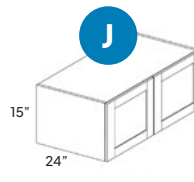
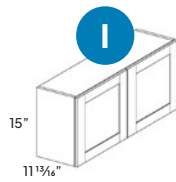
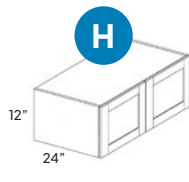
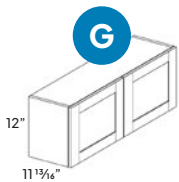

## BATHROOM CABINETS

### VANITIES AND MEDICINE CABINETS

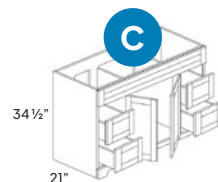
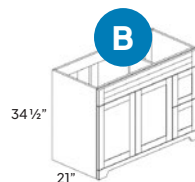
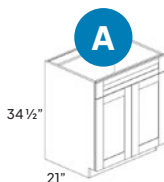



## PANELS, SKINS, AND FILLERS

### SKINS

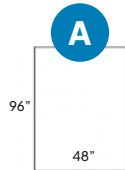

### TOE KICK

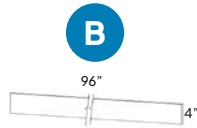

### FILLERS

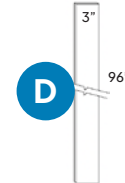
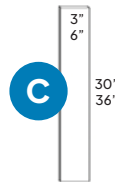

### END PANELS

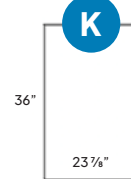
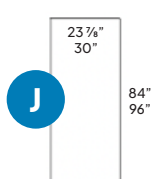
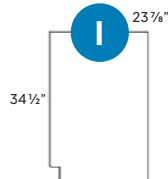
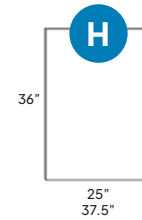
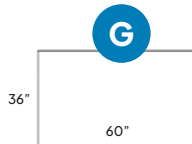
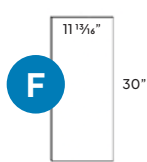
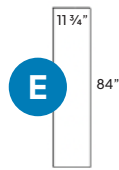

## MOLDING

### MOLDING

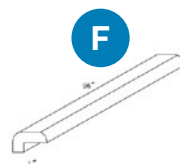
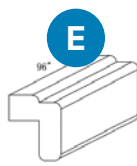
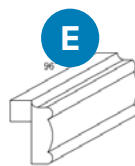
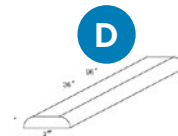
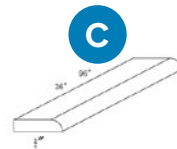
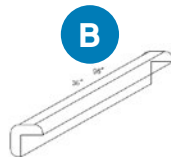
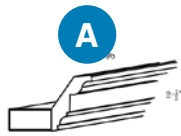

These are a sample of popular sizes and cabinet types that we stock. Additional options are available. Please contact us for the full selection.

# We're the partner you can depend on to meet your needs and exceed your expectations.

Our goal is to make your life easier through our commitment to quality, both in product and experience. We offer:



## EFFICIENCY AND CONVENIENCE WITH IN-STOCK CABINETRY

Our warehouse is fully stocked with a wide range of ready-to-assemble inventory to ensure reduced lead times and faster turnarounds, keeping your projects moving forward with minimal downtime. In the event of damage or defects, replacements can be quickly sourced and implemented.

## CONFIDENCE IN QUALITY MATERIALS

Our premium, quality cabinets are crafted with plywood frames, wood and HDF doors, dovetail drawers, and undermount hardware, ensuring durability and reliability that surpasses others made of cheaper materials. These well-made cabinets maximize lifespan and minimize maintenance, offering you a long-lasting, high-quality solution.

## EXPERT DESIGN, BEAUTIFUL RESULTS

Our timeless, elegant designs, coupled with modern storage solutions and a vast array of features, finishes, and configurations, offer endless possibilities to achieve your desired result.

## SEAMLESS, STRESS-FREE EXPERIENCE

We aim to make your life easier by handling your project with thoughtful care and attention to detail. Our sharpest focus is on taking the very best care of our customers, acting as your partner and fully invested in your success. You can depend on us to get the job done right and with integrity, every time.



[jjcabinetwarehouse.com](http://jjcabinetwarehouse.com) | 204-783-0870

**VISIT OUR SHOWROOM:**

406 Pacific Ave. Winnipeg, MB. R3A 0M5